

Signalsteckverbinder – CONINVERS signal

M16 – Serie PV

Gerätesteckverbinder gerade, Vorder-/Hinterwandmontage

PV...P1N126100 (Vorderwandmontage),

PV...P1N.2HG00 (Hinterwandmontage)

PV...P1N126100

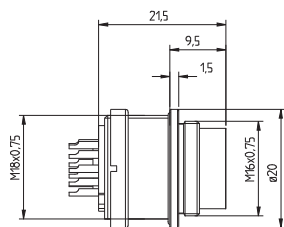

Lötanschluss

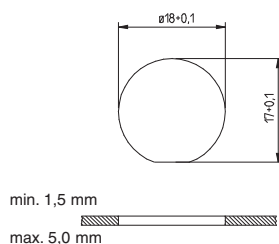

Einbaumaße

PV...P1N12HG00

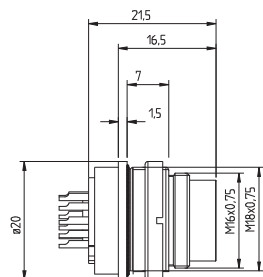

Lötanschluss

PV...P1N22HG00

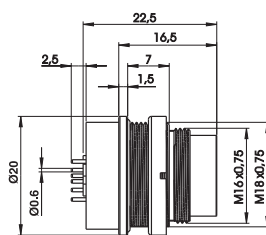

Einlötanschluss

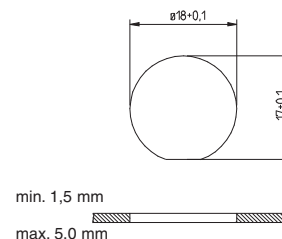

Einbaumaße

Leiterplattenlochbilder Einlötanschluss

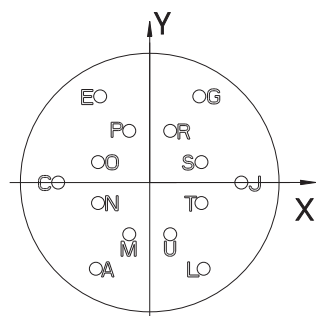

14-pol.

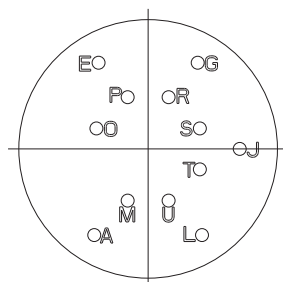

12-pol.

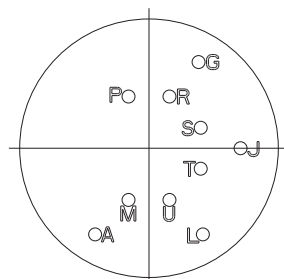

10-pol.

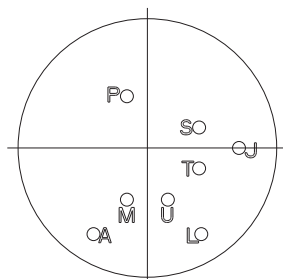

8-pol.

Bohrungsdurchmesser $0,8 \pm 0,05$ mm

	X	Y
A	- 2,5	- 4,0
C	- 4,25	0,0
E	- 2,3	4,0
G	2,3	4,0
J	4,25	0,0
L	2,5	- 4,0
M	- 0,95	- 2,4
N	- 2,4	- 0,95
O	- 2,4	0,95
P	- 0,95	2,4
R	0,95	2,4
S	2,4	0,95
T	2,4	- 0,95
U	0,95	- 2,4