

Taped C-HC crimp contacts

High performance for cost-effective processing

Stamped/rolled C-HC male and female contacts from CONINVERS guarantee reliable and permanent contacting, even under the most difficult application conditions.

The C-HC contacts are used wherever excellent mechanical and electrical properties are called for while keeping unit and processing costs low.

C-HC crimp contacts feature low insertion and withdrawal forces, high vibration resistance, mechanical stability and very high current carrying capacity.

Female contacts are available with 1-mm and 2-mm plug diameters, and C-HC male contacts with a 1-mm

plug diameter. The 2-mm variant is in preparation. The crimp connections process litz wire cross sections of 0.08 mm² up to 2.5 mm².

Suitable for crimping machines

The stamped/rolled C-HC crimp contacts are supplied taped. They can therefore be processed quickly and efficiently, manually or automatically, with the usual crimping tools, even in large quantities.

The following pages provide an overview of the available C-HC crimp contacts and crimping tools. The CONINVERS sales team would be happy to answer any questions you may have.

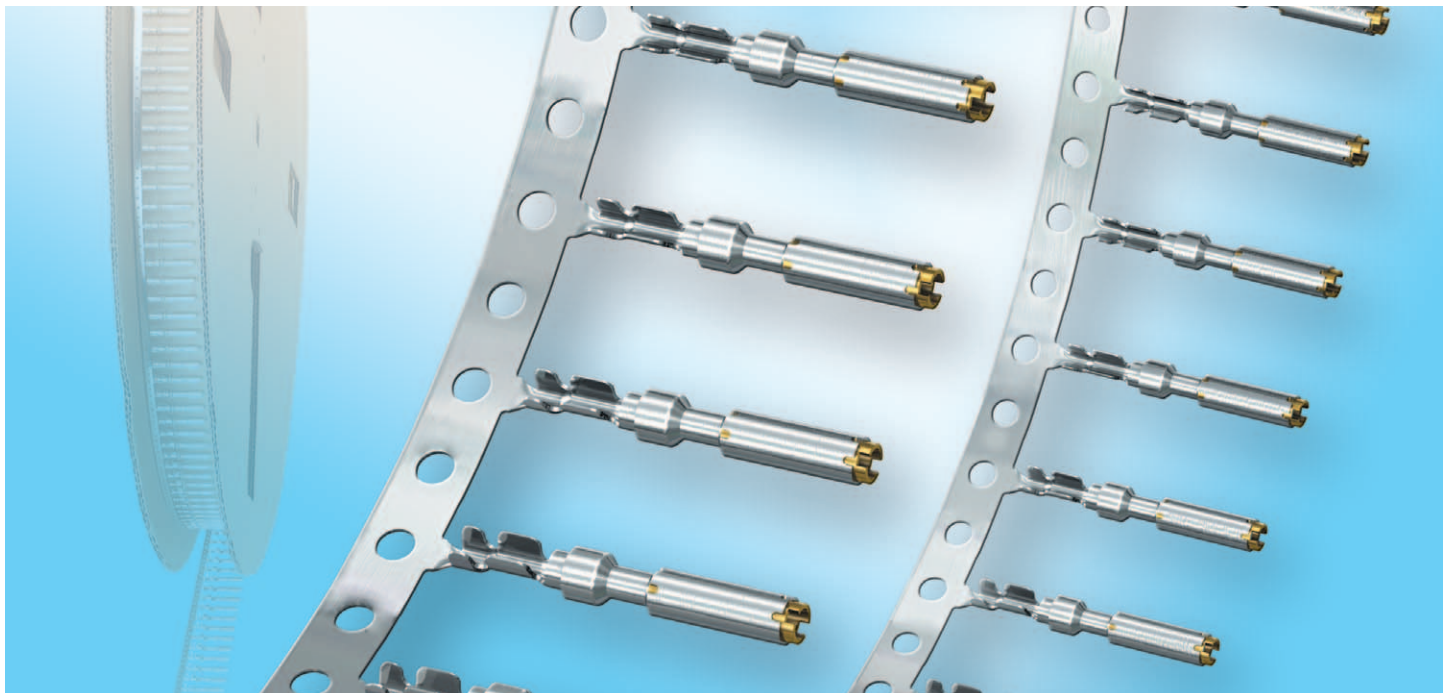

CONINVERS C-HC stamped/rolled crimp contacts Ø 1 mm / Ø 2 mm



Ordering information

CONINVERS C-HC are stamped/rolled crimp contacts with integrated wire and insulation crimping. The contacts are supplied taped on reels with 2,500 or 10,000 pieces. Packages with 100 or 200 taped contacts are available for processing small quantities.



C-HC female contacts Ø 1 mm/Ø 2 mm



C-HC male contacts Ø 1 mm

SF-10KS..., SF-20KS...

SF-10KP...

Description	Connection cross section [mm²]	Type	Order No.	Pcs. Pkt.	Type	Order No.	Pcs. Pkt.
C-HC contacts stamped/rolled, Ø 1.0 mm, taped on reels with 10.000 pieces	0.08-0.2 0.2-0.56	SF-10KS330 SF-10KS360	16 07 35 8 16 07 36 1	1 reel	SF-10KP330 SF-10KP360	16 15 96 3 16 15 96 4	1 reel
C-HC contacts stamped/rolled, Ø 1.0 mm, taped on reels with 2.500 pieces	0.08-0.2 0.2-0.56	SF-10KS320 SF-10KS350	16 07 03 1 16 07 03 2	1 reel	SF-10KP320 SF-10KP350	16 15 96 1 16 15 96 3	1 reel
C-HC contacts stamped/rolled, Ø 1.0 mm, 200 taped contacts	0.08-0.2 0.2-0.56	SF-10KS410 SF-10KS430	16 16 83 7 16 07 36 0	1 tape	SF-10KP380 SF-10KP400	16 16 83 3 16 16 83 5	1 tape
C-HC contacts stamped/rolled, Ø 1.0 mm, 100 taped contacts	0.08-0.2 0.2-0.56	SF-10KS400 SF-10KS420	16 16 83 6 16 16 83 8	1 tape	SF-10KP370 SF-10KP390	16 16 83 2 16 16 83 4	1 tape
C-HC contacts stamped/rolled, Ø 2.0 mm, taped on reels with 4.000 pieces	1.0-2.5	SF-20KS560	16 16 93 1	1 reel			
C-HC contacts stamped/rolled, Ø 2.0 mm, taped on reels with 1.000 pieces	1.0-2.5	SF-20KS550	16 16 93 0	1 reel			
C-HC contacts stamped/rolled, Ø 2.0 mm, 200 taped contacts	1.0-2.5	SF-20KS510	16 16 92 9	1 tape			
C-HC contacts stamped/rolled, Ø 2.0 mm, 100 taped contacts	1.0-2.5	SF-20KS500	16 16 92 8	1 tape			

CONINVERS C-HC stamped/rolled crimp contacts Ø 1 mm / Ø 2 mm



Technical data

		Mating dia. 1 mm	Mating dia. 2 mm
Materials	Contact area	Copper alloy	Copper alloy
	Surface, contact area	0,85 µm gold (Au)	0,85 µm gold (Au)
	Surface, crimping area	Nickel (Ni) / Tin (Sn)	Nickel (Ni) / Tin (Sn)
	Surface, protective sleeve	Nickel (Ni) / Tin (Sn)	Nickel (Ni) / Tin (Sn)
Mechanical	Insertion/withdrawal cycles	10,000	< 100, higher on request
	Plug-in force [N]	< 3	< 6
	Contact retention force [N]	> 50	> 100
	Installation dimensions	see drawings below	see drawings below
Contact connection type	Crimp connection [mm²]	0.08 – 0.2 0.2 – 0.56	1.0 – 2.5
Electrical	Rated current [A]	10 (T _{amb} = 60 °C; 0.56 mm²)	30 (T _{amb} = 60 °C; 2.5 mm²)
	Through resistance [mΩ]	< 3	< 3
Thermal	Temperature range [°C]	-40 to +125	-40 to +125
Processing	Crimping requirements	DIN 41612, part 2	DIN 41612, part 2
	Crimping tools	automatically with crimping machine, manually with manual crimping pliers	automatically with crimping machine, manually with manual crimping pliers

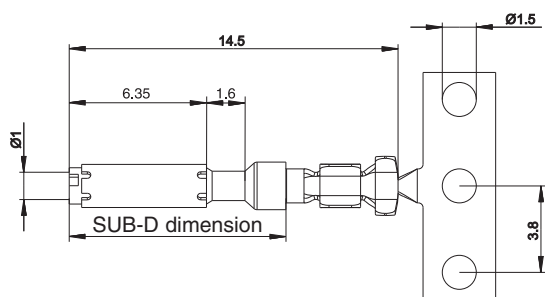

C-HC female contact Ø 1 mm

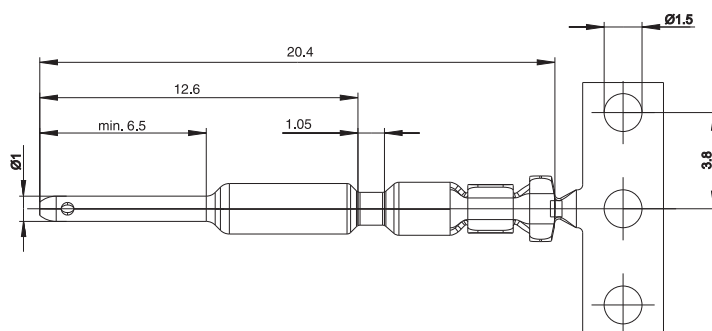

C-HC male contact Ø 1 mm

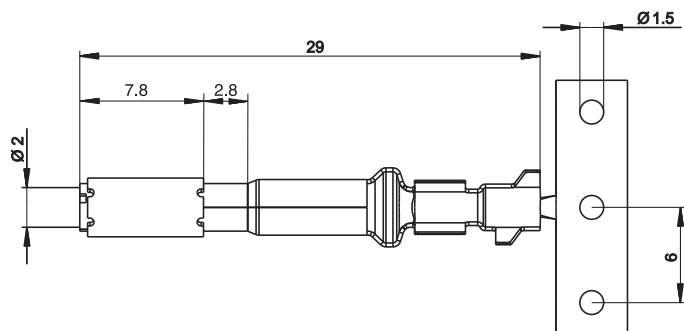

C-HC female contact Ø 2 mm

CONINVERS C-HC crimping tools

The stamped/rolled C-HC crimp contacts can be crimped quickly and efficiently, either manually or automatically.

Manual crimping pliers can be used for individual processing. An electric tabletop crimping device with an integrated feed mechanism is available for processing from reels. The tool heads are adapted to the respective contacts and connection cross sections.



Manual crimping pliers for stamped/rolled C-HC crimp contacts
SF-Z....



Electrical crimping tool for stamped/rolled C-HC crimp contacts
SF-Z....

Description	Type	Order No.	Pcs. Pkt.	Type	Order No.	Pcs. Pkt.
Manual crimping pliers, basic tool for individual processing of C-HC crimp contacts	SF-Z0029	16 07 45 8	1			
Tool head of manual crimping pliers SF-Z0029 for C-HC crimp contacts Ø 2 mm	SF-Z0030	16 07 45 9	1			
Tool head of manual crimping pliers SF-Z0029 for C-HC crimp contacts Ø 1 mm	SF-Z0031	16 07 46 1	1			
Electrical crimping tool for C-HC crimp contacts				SF-Z0032	16 07 46 2	1
Tool head of electrical crimping device SF-Z0032 for C-HC crimp contacts Ø 2 mm, 1.0 mm ² for processing taped contacts				SF-Z0033	16 07 46 3	1
Tool head of electrical crimping device SF-Z0032 for C-HC crimp contacts Ø 2 mm, 1.5 mm ² for processing taped contacts				SF-Z0047	16 14 68 9	1
Tool head of electrical crimping device SF-Z0032 for C-HC crimp contacts Ø 2 mm, 2.5 mm ² for processing taped contacts				SF-Z0035	16 07 46 5	1
Tool head of electrical crimping device SF-Z0032 for C-HC crimp contacts Ø 1 mm, 0.08 – 0.2 mm ² for processing taped contacts				SF-Z0039	16 07 47 0	1
Tool head of electrical crimping device SF-Z0032 for C-HC crimp contacts Ø 1 mm, 0.2 – 0.56 mm ² for processing taped contacts				SF-Z0040	16 07 47 1	1
Reel holder for SF-Z0032 elect. crimping device for accommodating rolls up to Ø 60 cm				SF-Z0052	16 15 41 3	1
Adapter for electrical crimping device SF-Z0032 for accommodating tool heads for individual processing				SF-Z0041	16 07 47 2	1

The adapter SF-Z0041 makes it possible to use tool heads of the manual crimping pliers for individual processing with the electrical crimping device.

Wire stripping lengths for stamped-rolled C-HC crimp contacts	Connection cross section [mm ²]	Wire stripping length [mm]
Female Ø 1.0 mm	0.08-0.2	2.5
	0.2-0.56	2.5
Female Ø 2.0 mm	1.0-2.5	5

Depending on the conductor used, the crimping pliers settings and the stripping lengths required may differ from the values given in the settings chart.